



Digitplan, the application that monitors agricultural or industrial facilities in real time

User-oriented monitoring software, where user can control the status of your installation in real time, using data obtained from the various level sensors (Silometric or Fluidmetric) or temperature sensors (SecurDetect), through any electronic device connected to the Internet.

Features

- Multiplatform.
- Real-time status and inventory display.
- Consultation of historical data in graphic format, exportable to a spreadsheet (csv).
- Geo-location of the devices.
- Low level alarms configuration
- Possibility of integration with other programs.

Services



Tank volume calculations tools.



Data display in all international measurement units.



Data calibration and corrections.



Historical data in graphical format and exportable to spreadsheet.



Alarm notifications via SMS or e-mail.



Direct API connection with other software applications.



Generate personalized user profiles.



Status and control diagnosis of the devices.



DigitPlan[®]

- Create different user profiles.
- Limited access to the platform depending on a user profile.



It is necessary to have installed at least one sensor. View **Silometric** technical card.

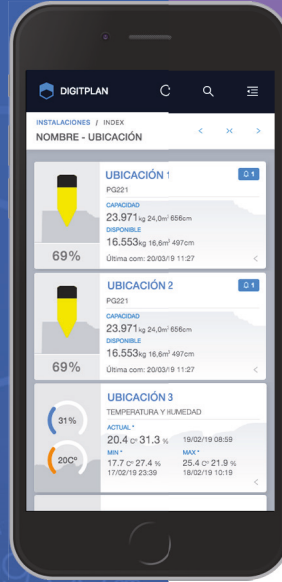

- Installation general dashboard.
- Temperature and moisture.
- Graphs of inventory.

- Inventory data historical and alarms.
- Geo-location.
- Material density set up and customization.
- Historical data exportable to CSV format.

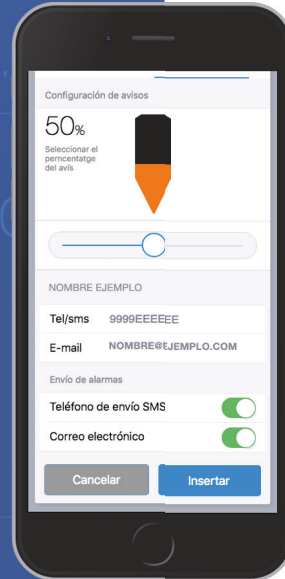
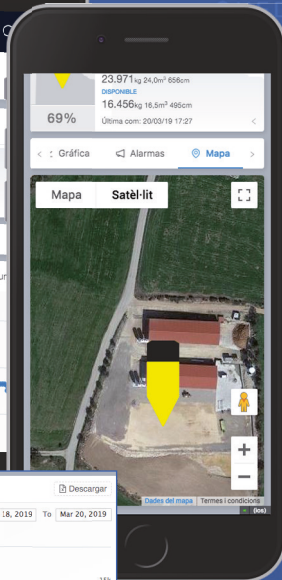
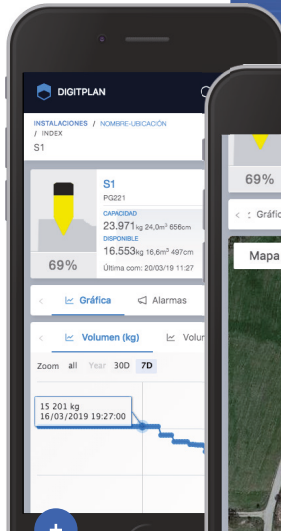

- Configuración de alarmas.
- Alarm notifications via SMS or e-mail.



Metrics are created from 3D models. Standard tanks and silos shapes are generated directly from DIGITPLAN software. Out of standard silos or tank shapes and dimension can be imported in 3D format.

